

# Grounding Connectors

## GFD Two Cable to Flat Surface

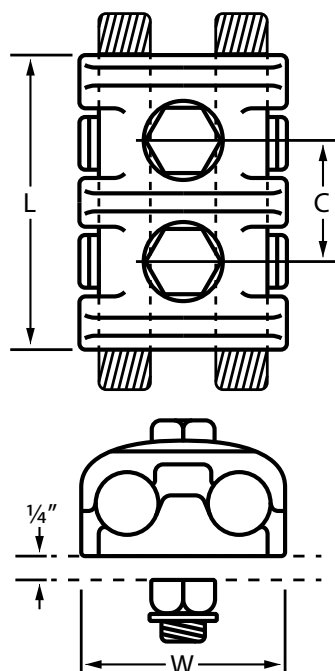
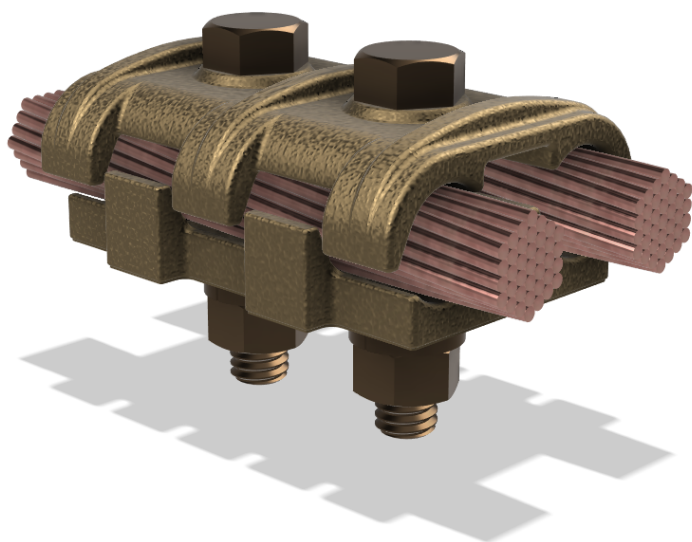

Types GFD is a two conductor grounding clamp that is simple in construction, yet designed to permit a single fitting to be used for a wide range of cable sizes. Body is cast of a high strength copper alloy, and is equipped with silicon bronze bolts, nuts and lock washers Bolts of sufficient length to grip 1/4 inch thick flat bar are provided unless otherwise specified.

CABLE RANGE*		CATALOG NUMBER		DIMENSIONS IN INCHES			BOLT DIAMETER
MINIMUM	MAXIMUM	TIN PLATE FINISH	BRIGHT DIP FINISH	C	L	W	
6	2/0	GFD-100	GFD-1000	1	2	1 9/16	3/8
1	4/0	GFD-200	GFD-2000	1 1/4	2 1/2	1 13/16	3/8
1/0	300	GFD-300	GFD-3000	1 1/4	2 7/8	2 1/16	3/8
300	500	GFD-400	GFD-4000	1 3/4	3 3/8	2 11/16	1/2
500	800	GFD-500	GFD-5000	1 3/4	3 1/2	3 1/4	1/2
750	1000	GFD-600	GFD-6000	2	4	3 5/8	1/2

For cross reference or other  
information, please contact us.  
[deltastarcc.com](http://deltastarcc.com)



**DELTA STAR  
CONNECTOR COMPANY**

